

Pluslife Mini Dock Set

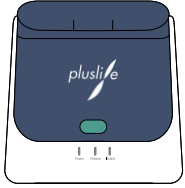

Pluslife Mini Dock



Card Holder

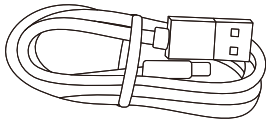

Type-C Cable

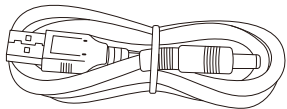

DC Power Cable

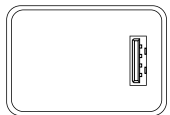

Power Adapter

Pluslife GBS Card Set

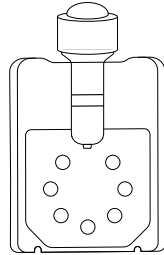

GBS Reaction Card

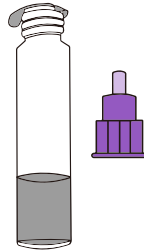

Nucleic Acid Releasing Agent 02



Waste Bag

Attention

1. If the foil bag of the test card is broken or bulging inside, please do not use it, and notify the manufacturer timely.
2. Set the computer to a non-sleep mode before testing.
3. Perform the test on a flat and stable surface. During testing, avoid shaking the instrument or holding up the instrument by hand, do not open the upper cover of the instrument, and do not press the button of the instrument again (unless it is turned off).
4. If power failure occurred during the test, the test result will be invalid. Please use the power adapter, Type-C cable, and DC cable provided by the manufacturer.
5. After the test is completed, if the test card is found to be leaking, please pack the test card together with the instrument in a sealed bag, and inform the manufacturer timely.
6. If you have any questions, please contact service@pluslife.com.



Scan QR code to download
product brochure



Scan QR code to download
PC Software & APP

Guangzhou Pluslife Biotech Co.,Ltd.

Version:A/2
Date: May., 2023

GBS NUCLEIC ACID TESTING CARD INSTRUCTION

01 Preparing

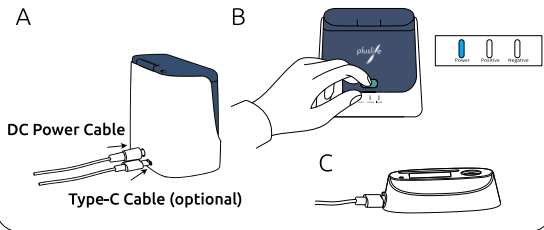

A. Connect DC power cable to power supply.
B. Press the button to start warm-up (about 2 mins). When the power light turns blue, warm-up is complete.
C. Run a thermostatic dry bath or water bath incubator and heat up to 65°C.
D. (Optional) Connect the Mini Dock to a computer with Type-C cable and open the installed Pluslife software.

02 Sampling

Vaginal Swab:

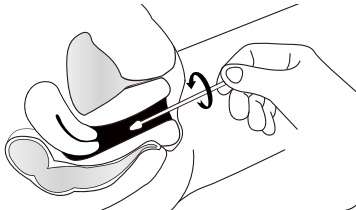

Vaginal Swab: Insert swab 2 cm into vagina, and rotate the swab for several seconds against the inner wall of vaginal.

03 Sample Treatment

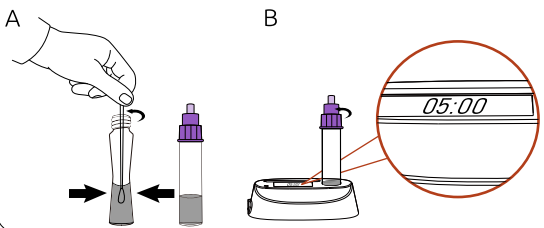

A. Rotate the swab in the Nucleic Acid Releasing Agent 02 Vial 10 times while pinching the swab by the tip. Discard the swab and tighten the cap.
B. Place it in a thermostatic dry bath or water bath system preheated to 65°C and incubate for 5mins.

04 Transferring to Reaction Card

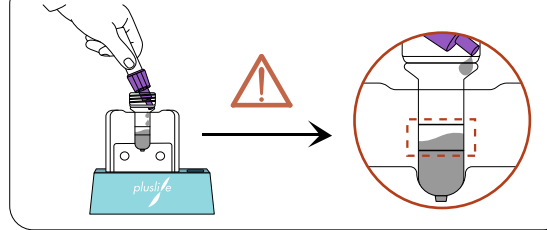

Pinch the vial to transfer the releasing agent into the Card through the nozzle. **MAKE SURE** the liquid is between the two level lines.

05 Screw on the Cap Correctly

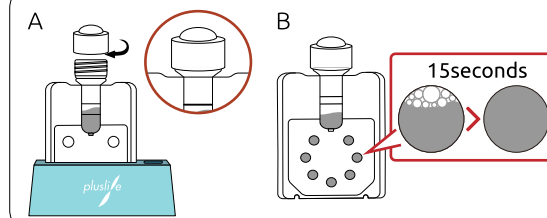

A. Screw the tube cap of the Card until it is tight. If it is not airtight, the test could fail or give an invalid result.
B. Allow the card stand still for 15 seconds to prevent bubbles from affecting the test result.

06 Moving Liquid into Reaction Chamber

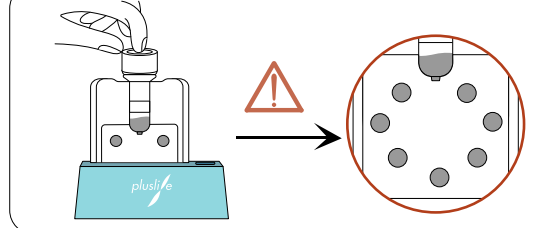

Firmly press the air button on top of the Card cap. Wait 10 seconds, to ensure that ALL chambers are completely filled with liquid.

07 Mixing

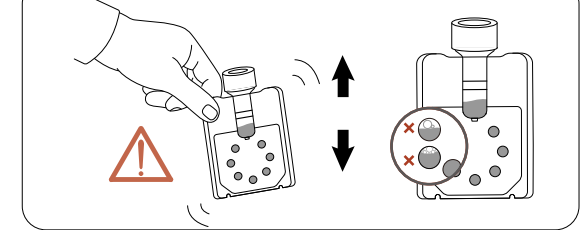

Quickly shake the Card up and down 10 times within 5 seconds. Discard the card if the bubble volume occupies more than 1/3 of the chamber.

08 Amplification

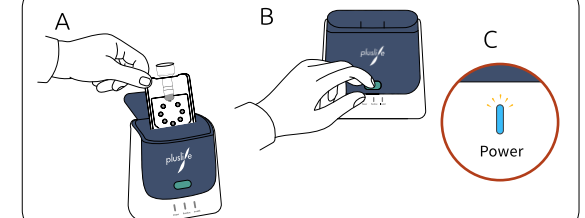

A. Insert the reaction Card into Mini Dock and close the top cover.
B. Press the button to start amplification.
C. The power light will flash blue during the amplification process. Read the results after 15 to 35 minutes.

09 Test Results

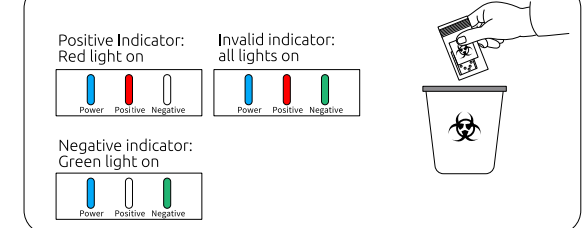

The test result is displayed on the software. After the test, dispose of the reaction card in the waste bag and seal the bag ASAP. If move on to next test, press the power button to eliminate the last test result (the power indicator is steady on), then back to STEP2. If not, press the button for over 3 seconds to turn it off.